

Rossmax Pencil Thermometer TG380

Quick Guide

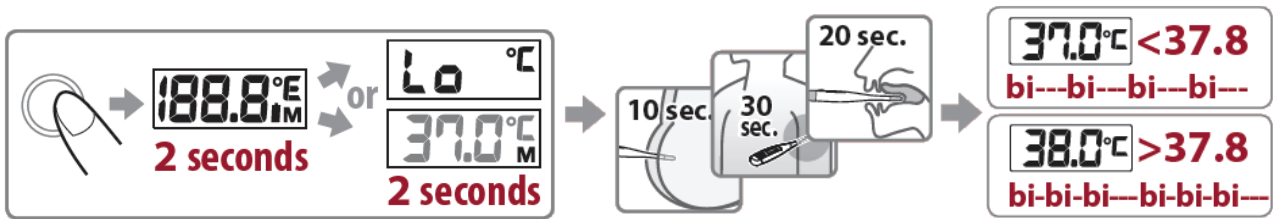

How to Use

1. To push the On/Off button by the display window. The display will read for 2 seconds and beep sound will be heard.
2. Releasing the on/off button, last measured temperature will be shown for about 2 seconds. Then shows the self-test temperature 37.0°C (98.6°F), and then Lo°C (Lo°F) displays.
3. Wipe or dip the probe with alcohol for disinfection. Position the probe in oral, rectal or axillary site.
4. Once the degree sign °C (°F) on the display has stopped flashing (usually within 10 to 40 seconds), a Beep signal will sound for approx. 10 times, the measured temperature is shown on LCD window. The temperature reading will not change after the unit is removed from testing position.

If the temperature $< 37.8^{\circ}\text{C}$ (100.0°F), the buzzer will alarm "Bi---Bi---Bi---Bi---".

If the temperature $\geq 37.8^{\circ}\text{C}$ (100.0°F), the buzzer whose frequency is higher will alarm "Bi-Bi-Bi---Bi-Bi-Bi---" about 10 times rather than "Bi---Bi---Bi---Bi---"

5. The unit will automatically turn off in 10 minutes for energy-saving. However, to prolong the life of the battery, it is suggested to press the On/Off button to turn the unit off once the measurement is done.
6. Please dispose of any used battery and the thermometer according to the local regulations.

Note: After step 2, if the room temperature is greater than 32.0°C (89.6°F), it will be displayed the room temperature.

Note: Usage of the probe cover may result in a 0.1°C (0.2°F) difference from actual temperature.

Note: To clean the probe before and after using the thermometer to ensure an accurate reading and avoid cross contamination approximately.

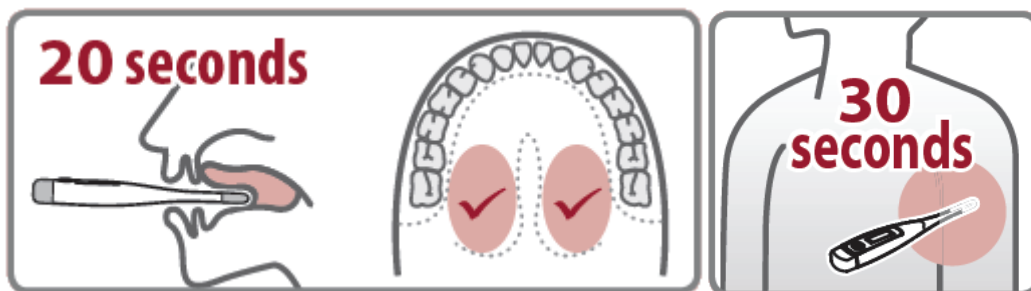

Oral Use

1. Place the probe well under the patient's tongue.
2. Confirm the patient to keep his mouth closing for about 20 seconds.

Do not drink hot or cold fluids, exercise, and smoke or perform other activities prior to a reading. These activities will raise or lower temperature readings when compared to your normal, average temperature.

Axillary Use

1. Tightly place probe in the patient's armpit for about 30 seconds.

* Please ensure the close contact between the probe and the armpit of the baby or children.



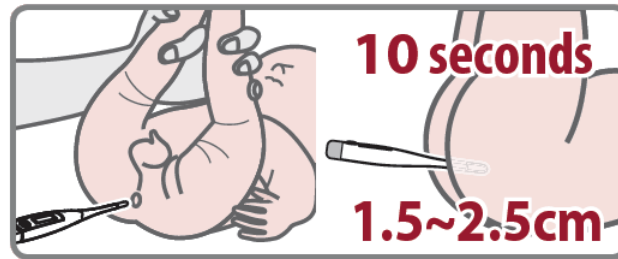

Rectal Use

Always uses probe cover when taking rectal measurements.

1. Commonly used for young children when it is difficult to take an oral or axillary temperature.
2. Lubricate with a water-soluble gel.
3. Gently insert the probe tip no more than 1.5-2 cm into the rectum for about 10 seconds. Do not force the tip into the rectum if resistance is encountered.
4. Disinfect the thermometer after use. Refer to “cleaning and disinfection” section.

Cleaning and Disinfection

1. Clean the unit by wiping it with a dry cloth and sterilize the probe with ethyl alcohol.
2. Don't let the unit contact any chemical thinner.
3. Not waterproof. Do not soak the display in water. Only the probe is waterproof.

Cautions

- If the unit is stored in an extreme environment before measurement, please make sure it has been firstly adapted in the room temperature, so that the unit can be measured normally.
- Please note that this is a home healthcare product only, and it is not intended to serve as a substitute for the advice of a physician or medical professional.
- Do not use this device for diagnosis or treatment of any health problem on disease. Measurement results are for reference only. Contact your physician if you have or suspect any medical problems.
- Do not change your medications without the advice of your physician or healthcare professional.
- Do not drink hot or cold fluids, exercise, and smoke or perform other activities prior to a reading. These activities will raise or lower temperature readings when compared to your normal, average temperature.
- Please ensure the close contact between the probe and the armpit of the baby or children.

Remarks: Please consult your doctor for the interpretation of results and diagnosis.

